

BRIGADOON



## C O N T E N T S

|               |    |
|---------------|----|
| INTRODUCTION  | 3  |
| BRIGADOON     | 7  |
| SPECIFICATION | 8  |
| YACHT LAYOUT  | 10 |
| MAIN DECK     | 13 |
| LOWER DECK    | 31 |
| BRIDGE DECK   | 43 |
| SUN DECK      | 55 |
| CREDITS       | 67 |

I N T R O D U C T I O N



## A B O U T U S

Studio Indigo is a multidisciplinary practice specialising in Architecture, Interior Design, Yachts and Estate Management. With experienced and talented professionals from all disciplines working together, we have built a reputation for outstanding quality and meticulous attention to detail.

Our national and international profile extends across a diverse range of sectors, including private homes, luxury residential, commercial developments, super yachts and private jets.

The studio comprises an eclectic group of professionals from 22 countries who speak 17 languages. Founded on a core project base of houses and apartments in prime Central London, the Studio's project list includes some of the most spectacular work in central London, the English countryside and a hugely diverse range of projects around the world.

Our work can be seen in Moscow, St Petersburg, Cape Town, Mumbai and St. Mortiz, amongst others with our third super yacht completed which won a World Superyacht Award in May 2017. We have a reputation for creating inspiring and imaginative spaces of outstanding quality, with meticulous attention to detail. Our designs are classic, yet contemporary and stand the test of time.

We are committed to listening to our clients and skilfully interpreting their wishes and desires, acting as their trusted advisors across all stages of a project.

Based in a converted warehouse overlooking the Thames in Chelsea, our talented group of professionals work closely with the highest quality craftsmen, artisans, tradesmen and specialists to deliver projects of outstanding quality.

  
“The mavericks of superyacht design”

SUPERYACHT TIMES



“Rising out of the Scottish mist only one every 100 years, and only for one day, Brigadoon is an enchanted place where life is simpler and easier, untouched by the worries of the modern world”

**B R I G A D O O N**  
(n) a place that is idyllic, unaffected by time



## M O O N E N M A R T I N I Q U E

Brigadoon is the first superyacht to feature a hull made of high-tensile steel. She heralds an exciting new course for the Shipyard as it takes a fresh approach to the signature Moonen aesthetic while leveraging on the yard's rich DNA in terms of comfort and performance.

Brigadoon has her origins in the Moonen Martinique line, part of the Moonen Caribbean design family. She has an impressive top speed of 17 knots for a displacement hull and a long capable range of 4000 nautical miles. The yacht features a remarkable amount of luxury space for her length thanks to a wide-body superstructure with the same beam as the hull.

This yacht was designed to target the niche in the market that aims specifically at the most discerning clients, who demand Dutch build quality and engineering.

“We were pretty impressed from the start – the boat exemplified Dutch build quality and was very impressive. Super yacht quality in a 36 metre build – it was ‘Lilliput’ personified”

OWNER OF BRIGADOON

## S P E C I F I C A T I O N S

|                 |                                     |
|-----------------|-------------------------------------|
| Length          | 36,3m / 119ft                       |
| Beam            | 8,00m / 26,02ft                     |
| Draught         | 2,15m / 7,0ft                       |
| Gross Tonnage   | 334 GT                              |
| Fuel capacity   | 35,000 litres / 9,250 US Gallons    |
| Water capacity  | 8,000 litres / 2,115 US gallon      |
| Main engines    | 2x Caterpillar C32 Acert (1417 BkW) |
| Maximum speed   | 16,5 knots                          |
| Cruising speed  | 14,5 knots                          |
| Range           | 3,900 nautical miles                |
| Naval architect | Diana Yacht Design                  |
| Exterior design | René van der Velden                 |
| Interior design | Studio Indigo / Nauta Design        |



# YACHT LAYOUT

## Sun Deck

1. Sun Deck

## Bridge Deck

1. Bridge Deck Dining
2. Winter Garden
3. Captain's Cabin
5. Wheel House
6. Bow Sitting area

## Main Deck

1. Main Deck Dining
2. Main Salon
3. Galley
4. Owner's Dressing Room
7. Owner's Stateroom
8. Owner's Ensuite

## Lower Deck

1. Tender Garage
2. Engine Room
3. Double Cabin
4. Double Cabin
5. Guest Lobby
6. Twin Cabin
7. Twin Cabin
8. Crew Area

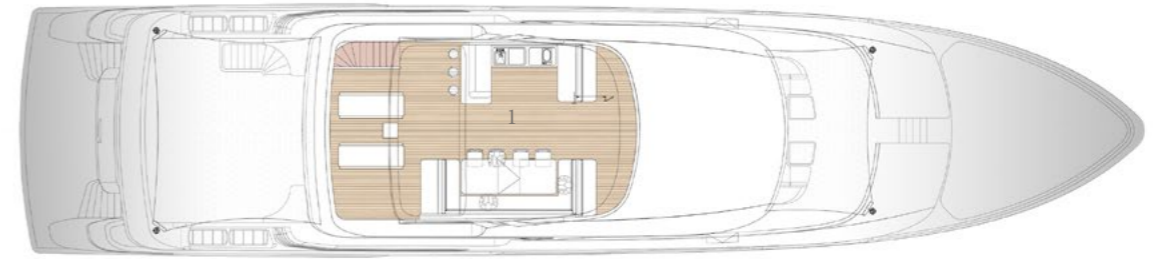
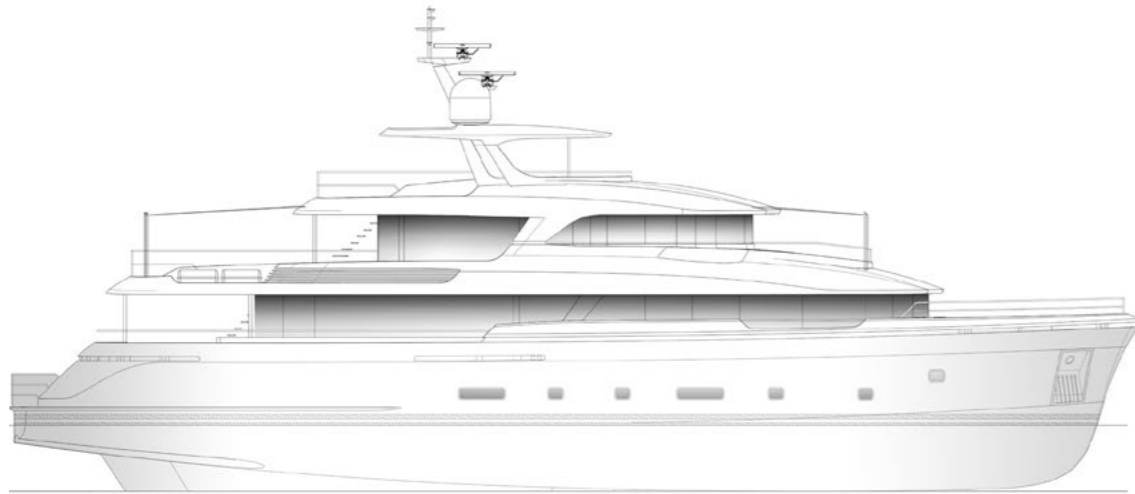

SUN DECK

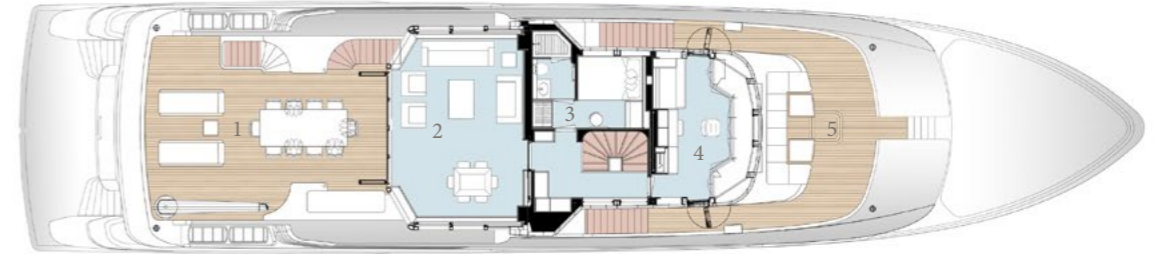

BRIDGE DECK



MAIN DECK



LOWER DECK





“Look deep into nature, and you will  
understand everything better”

ALBERT EINSTEIN

M A I N D E C K



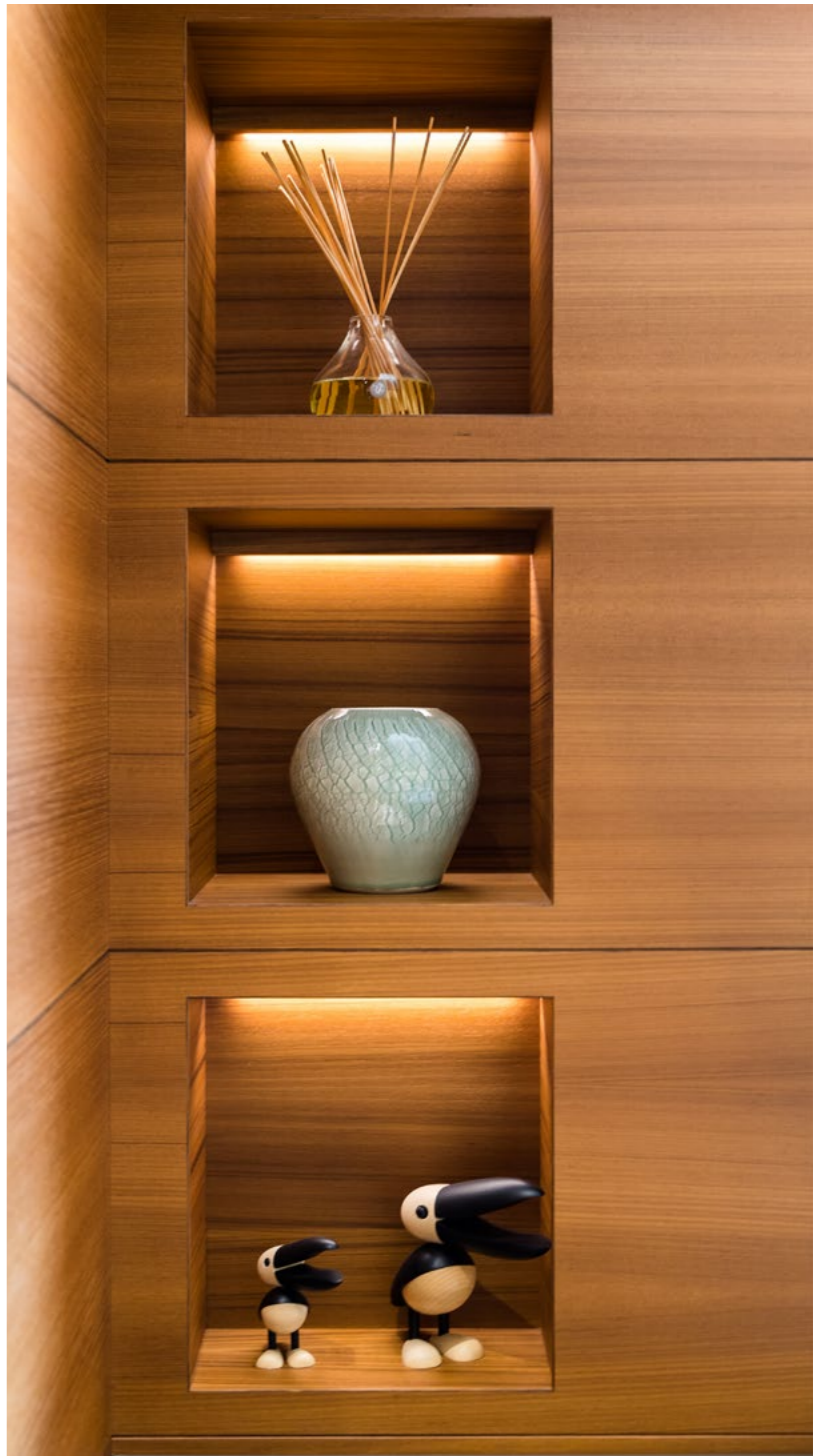















“Exploration is really the essence of  
the human spirit”

FRANK BORMAN

L O W E R   D E C K













“You cannot swim for new horizons  
until you have the courage to lose  
sight of the shore”

WILLIAM FAULKNER

B R I D G E   D E C K













“The sun does not realise how  
wonderful it is until after a room is  
made”

LOUIS KHAN

S U N D E C K





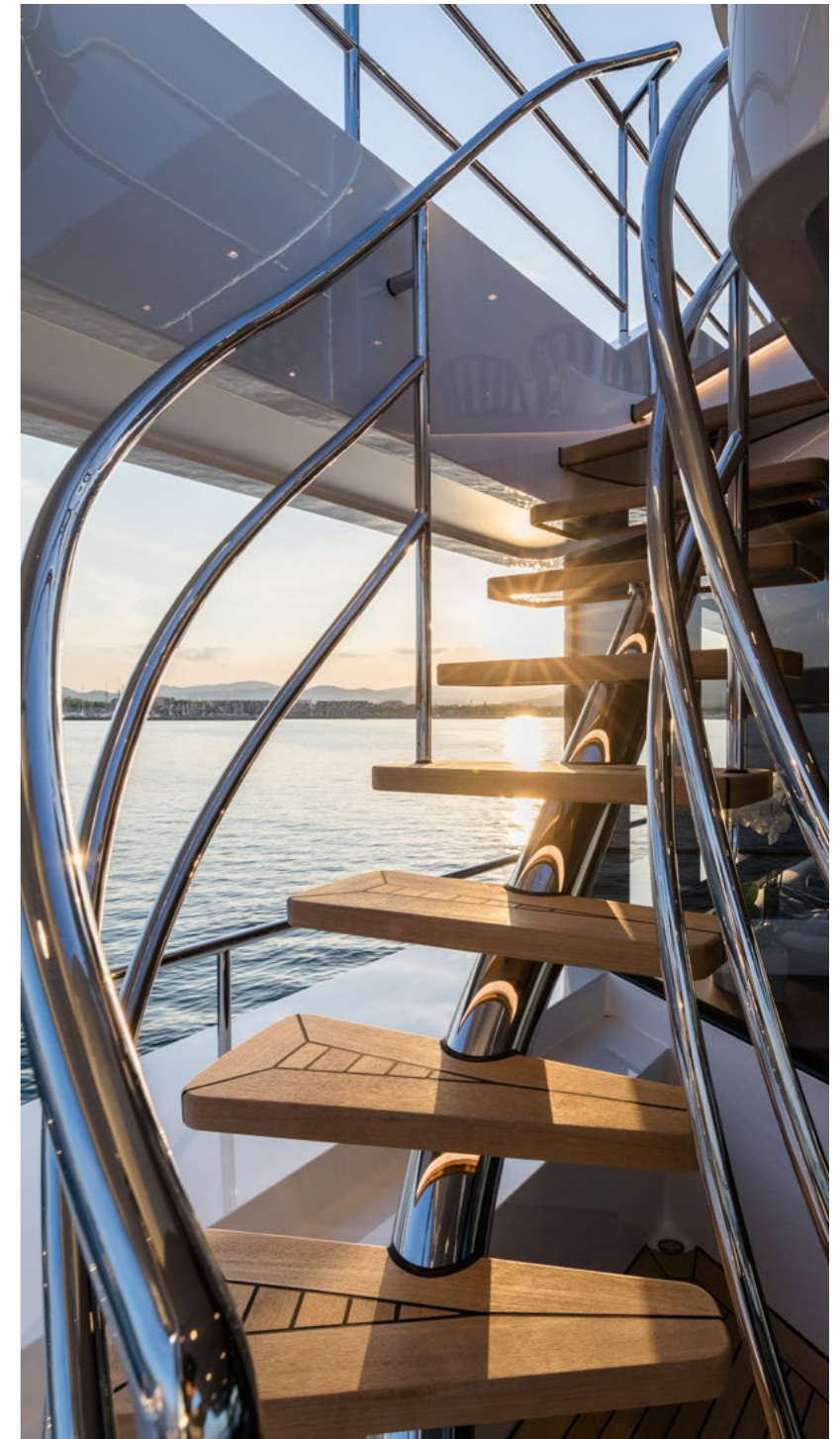







## T H E E N D

SHIPYARD:  
Moonen Yachts

NAVAL ARCHITECT:  
Diana Yacht Design

EXTERIOR ARCHITECT:  
René van der Velden

INTERIOR DESIGN:  
Studio Indigo / Nauta Design

PHOTOGRAPHY BY:  
Breed Media

PUBLISHED & CREATED BY:  
Studio Indigo

studio  
Indigo